

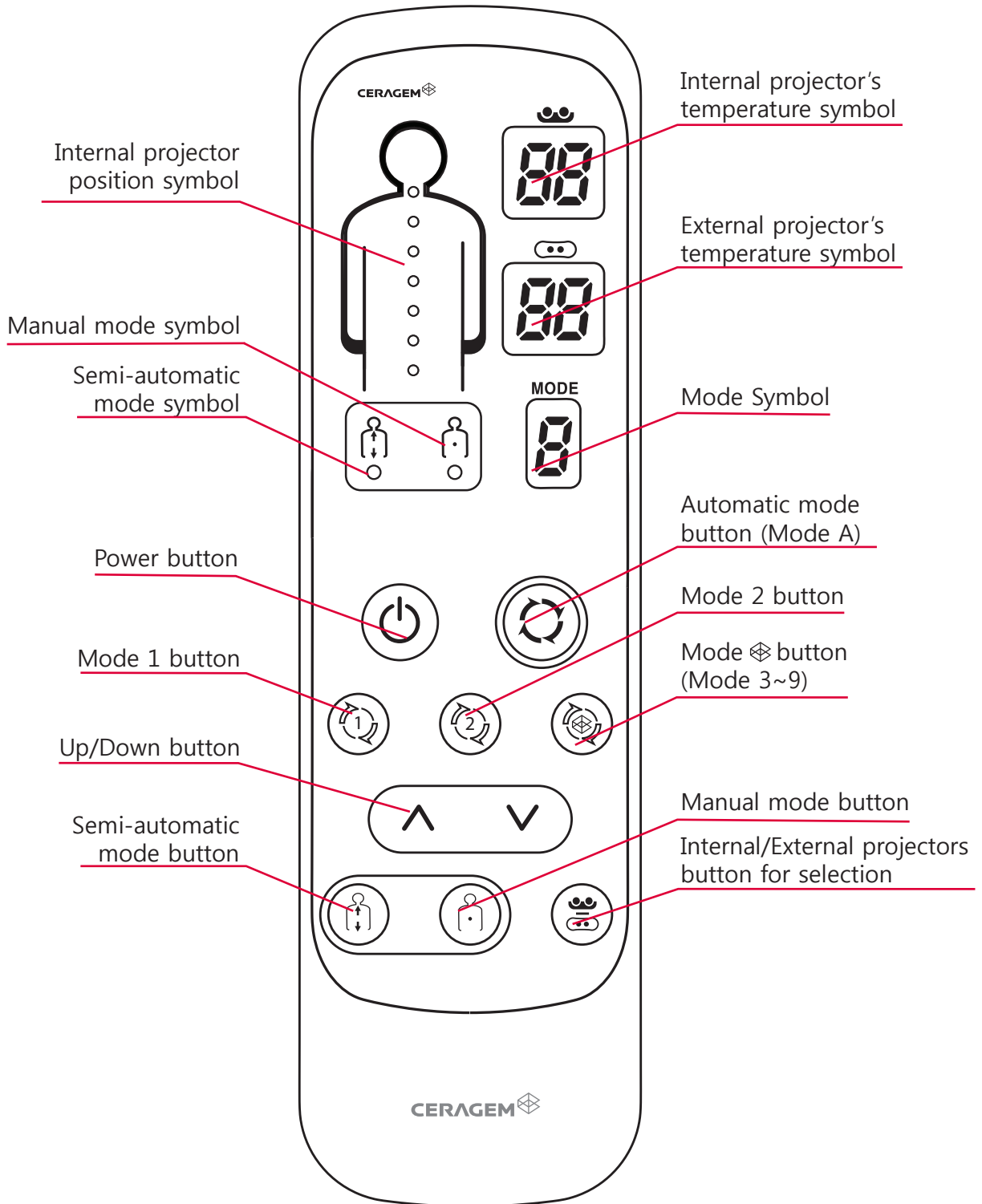

1. Remote control layout





2. How to use the remote control

Turning on the Remote Control

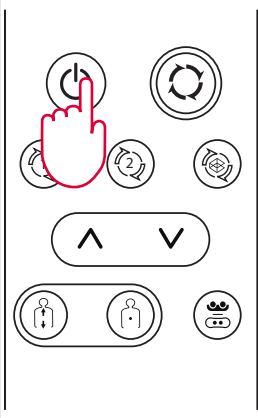

1. Check the condition of the product connections and press the power key of the remote control.

- Start the remote control after opening the auxiliary part.
- Press the remote control for 2~3 seconds to turn it off.

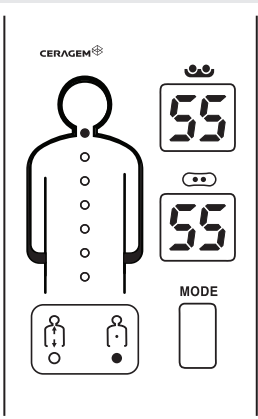

2. Check the display on the remote control.

- External projectors appear only when they are connected.
- The current temperature is displayed, and the standby state is shown.
- Refer to pages 21~26 for the mode selection.
- Refer to page 20 for details on how to adjust the temperature.

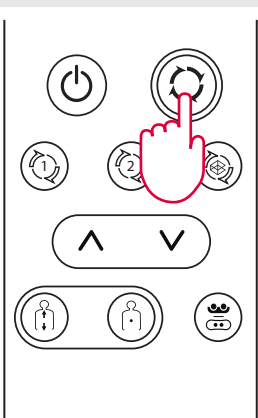

3. Select the mode to be used.



2. How to use the remote control

Adjusting the Temperature

The temperature of the internal projector and external projector can be adjusted when the mode is in use.

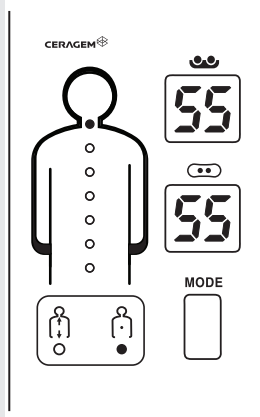

1. Check the current temperature.

- If you press the Internal/External projectors button for selection, the setting temperature display for the projector will flash, and a buzzer sound will be emitted. (The temperature is in standby state.)

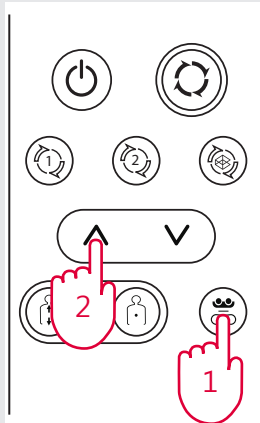

2. Press the temperature key and set the temperature to the desired level using the Up/Down button.

- The temperature can be adjusted by 1°C.
- If you do not press the button for 5 seconds in temperature standby state, the temperature is converted into the current level when the temperature setting is completed.



Pressing once (Internal projector temperature selected)



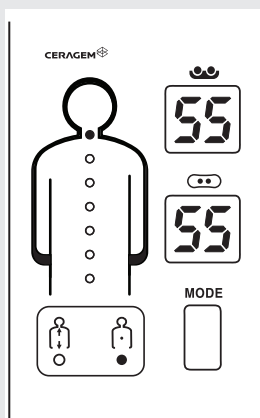

Pressing repeatedly (External projector temperature selected)



3. Check the changed temperature set point on the remote control display.

- If you do not press the setting button after setting the temperature by pressing the internal/external projectors' temperature, the temperature is converted into the current level after the temperature display blinks for about 5 seconds.

	
Internal projector	External projector
30°C~65°C	30°C~60°C